

4.00mm .156" Center Wire to Board Connector



4000 Series

■ TERMINAL

- Part No.: 4000-T-T-S
- Material: Phos. bronze
- Thickness: 0.2mm
- Plating: Tin plated 60u"
- Wire Range: Suitable for AWG#22~28
- Insulation O.D: 2.4mm (max)
- Q'TY: 5,000 pcs/reel
- Accepts housing : 4000-H

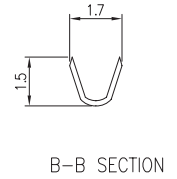
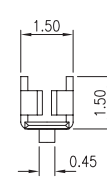
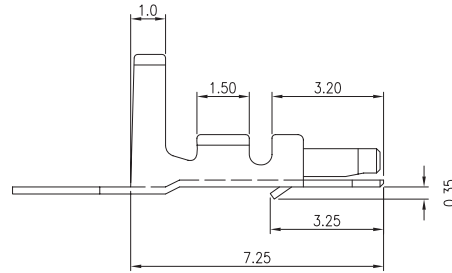
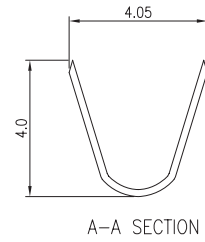
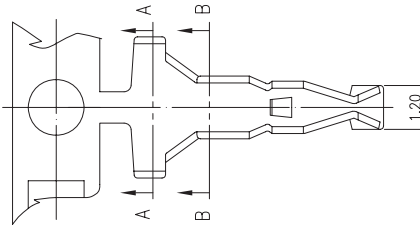

Ordering Information

Part No.	Wire Range	Insulation O.D.	Material	Finish	Q'ty/reel
4000-T-T-S	AWG #22~#28	2.4mm (max)	Phos. bronze	Tin Plated	5,000 pcs

4000 Series

■ HOUSING

- Part No.: 4000-H
- Material: Nylon 66, UL94V-0
- Pitch: 4.0mm (.156")
- Poles: 2~4
- Q'TY: 1,000 pcs/bag
- Accepts terminals : 4000-T-T-S
- Mates with: 4000-SMTR

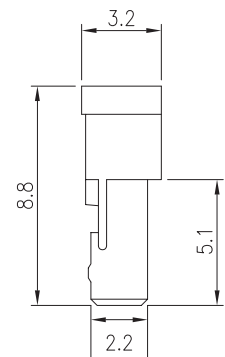
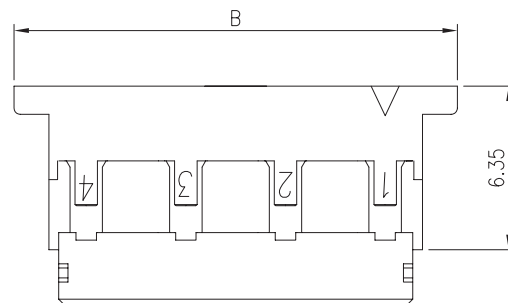
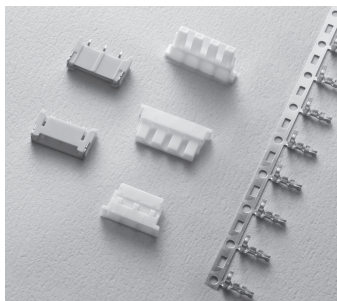
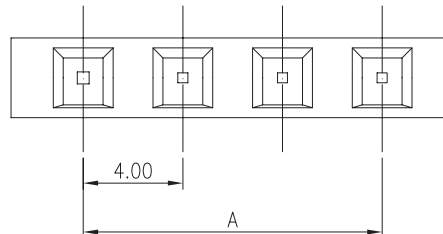

Ordering Information and Dimensions

CIRCUITS	PART NO.	DIMENSION	
		A	B
2	4000-H-02P	4.00	9.80
3	4000-H-03P	8.00	13.80

CIRCUITS	PART NO.	DIMENSION	
		A	B
4	4000-H-04P	12.00	17.80