

1.50mm .059" Center Wire to Board Connector



1503 Series

■ TERMINAL

• Part No.: 1503-G-P
1503-T-T-S

- Material: Phosphor bronze
- Thickness: 0.15mm
- Plating: Gold plated, Tin plated
- Applicable Wire: AWG#24~28
- Insulation O.D: 1.10mm (Max)

• Accepts housing: 1503-H-xxP

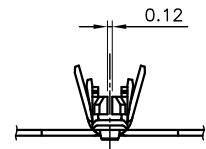
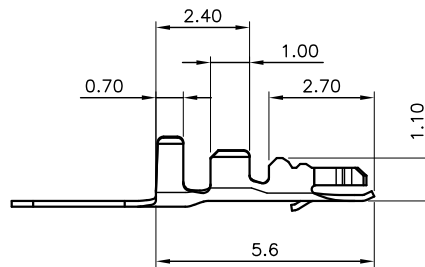
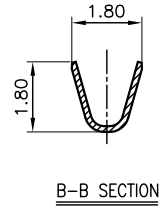
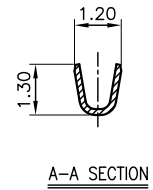
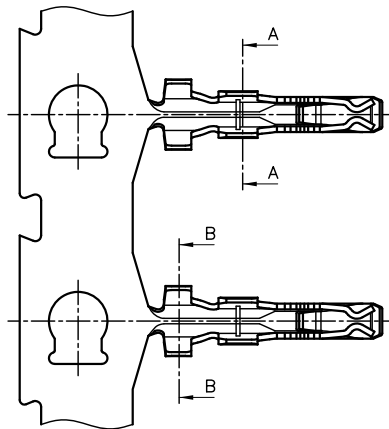
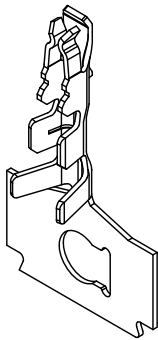

1503 Series

■ HOUSING

• Part No.: 1503-H-xxP

- Material: Nylon 66, UL 94V-0
- Pitch: 1.50mm (.059")
- Circuits: 2~12
- Color: Natural
- Accepts terminal: 1503-G-P
1503-T-T-S

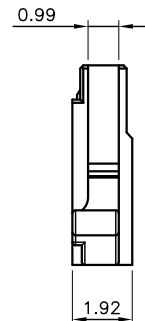
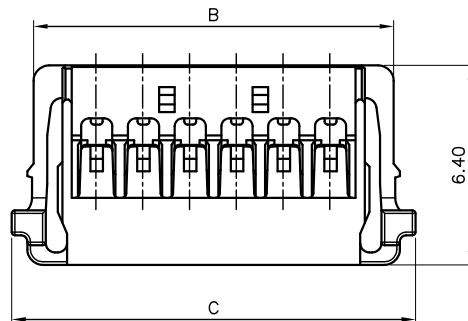
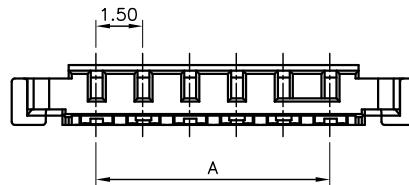
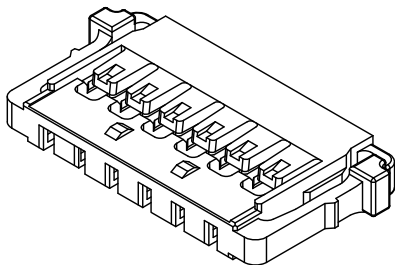

Ordering Information and Dimensions

CIRCUITS	PART NO.	DIMENSION		
		A	B	C
2	1503-H-02P	1.50	5.55	6.95
3	1503-H-03P	3.00	7.05	8.45
4	1503-H-04P	4.50	8.55	9.95
5	1503-H-05P	6.00	10.05	11.45
6	1503-H-06P	7.50	11.55	12.95

CIRCUITS	PART NO.	DIMENSION		
		A	B	C
8	1503-H-08P	10.50	14.55	15.95
10	1503-H-10P	13.50	17.55	18.95
12	1503-H-12P	16.50	20.55	21.95