

1.25mm .049" Center Board - In Type Connector



1259 Series

■ TERMINAL

- Part No.: 1259-T-T-S
- Material: Phos. bronze
- Thickness: 0.15mm
- Plating: Tin plated
- Wire Range: Suitable for AWG#28~32
- Insulation O.D: 1.04-0.6mm (max)
- Q'TY: 15,000 pcs/reel
- Accepts housing : 1259-H

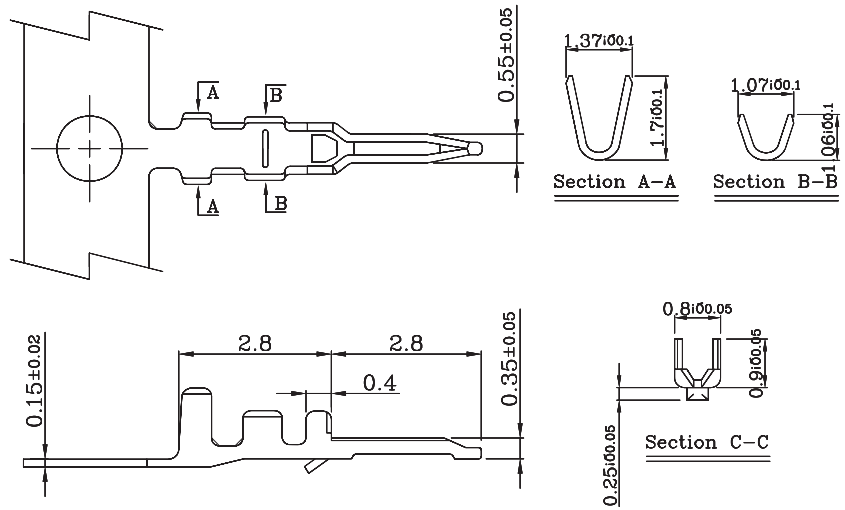

Ordering Information

Part No.	Wire Range	Insulation O.D.	Material	Finish	Q'ty/reel	Note
1259-T-T-S	AWG #28~#32	1.04-0.6 (mm)	Phos. bronze	Tin Plated	15,000 pcs	

1259 Series

■ HOUSING

- Part No.: 1259-H
- Material: PBT UL 94V-0
- Pitch: 1.25mm (.049")
- Poles: 2~15
- Q'TY: 1,000 pcs/bag
- Accepts terminals : 1259-T-T-S

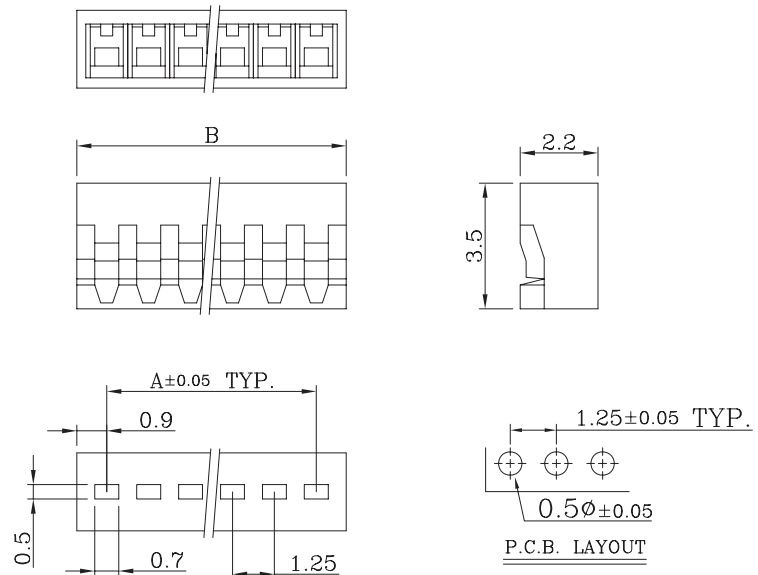
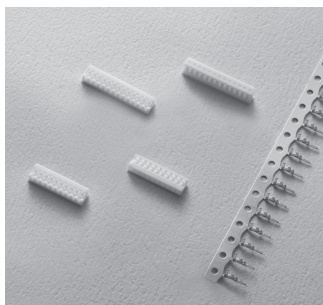

Ordering Information and Dimensions

CIRCUITS	PART NO.	DIMENSION	
		A	B
2	1259-H-02P	1.25	3.05
3	1259-H-03P	2.50	4.30
4	1259-H-04P	3.75	5.55
5	1259-H-05P	5.00	6.80
6	1259-H-06P	6.25	8.05
7	1259-H-07P	7.50	9.30
8	1259-H-08P	8.75	10.55

CIRCUITS	PART NO.	DIMENSION	
		A	B
9	1259-H-09P	10.00	11.80
10	1259-H-10P	11.25	13.05
11	1259-H-11P	12.50	14.30
12	1259-H-12P	13.75	15.55
13	1259-H-13P	15.00	16.80
14	1259-H-14P	16.25	18.05
15	1259-H-15P	17.50	19.30