

1.25mm .049" Center Wire to Board Connector



1255 Series

■ WAFER

- Part No.: 1255-WS-xxP

Specifications

- Electrical
- Voltage Rating: 100V AC,DC
- Current Rating: 1A
- Withstanding Voltage: 800V AC/ minute
- Insulation Resistance: 1000MΩ Min
- Mates with: 1255-H-xxP

Material

- Circuits: 2~15
- Housing: Nylon 66, UL 94V-0
- Pin: Brass, Tin plated
- Temperature Range: -25~+85°C

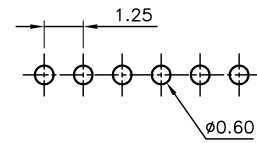
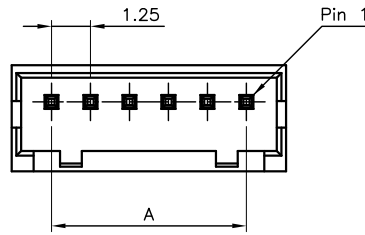
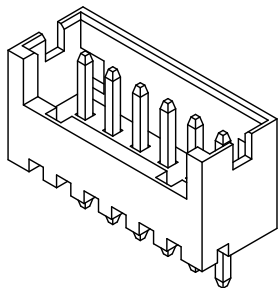

PCB PATTREN LAYOUT

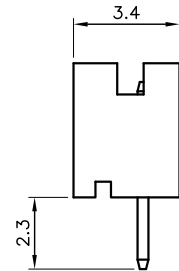
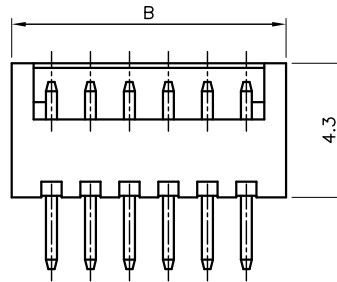

Ordering Information and Dimensions

CIRCUITS	PART NO.	DIMENSION	
		A	B
2	1255-WS-02P	1.25	3.80
3	1255-WS-03P	2.50	5.05
4	1255-WS-04P	3.75	6.30
5	1255-WS-05P	5.00	7.55
6	1255-WS-06P	6.25	8.80
7	1255-WS-07P	7.50	10.05
8	1255-WS-08P	8.75	11.30

CIRCUITS	PART NO.	DIMENSION	
		A	B
9	1255-WS-09P	10.00	12.55
10	1255-WS-10P	11.25	13.80
11	1255-WS-11P	12.50	15.05
12	1255-WS-12P	13.75	16.30
13	1255-WS-13P	15.00	17.55
14	1255-WS-14P	16.25	18.80
15	1255-WS-15P	17.50	20.05

1255 Series

■ WAFER

- Part No.: 1255-WR-xxP

Specifications

- Electrical
- Voltage Rating: 100V AC,DC
- Current Rating: 1A
- Withstanding Voltage: 800V AC/ minute
- Insulation Resistance: 1000MΩ Min
- Mates with: 1255-H-xxP

Material

- Circuits: 2~15
- Housing: Nylon 66, UL 94V-0
- Pin: Brass, Tin plated
- Temperature Range: -25~+85°C

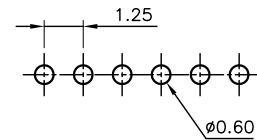
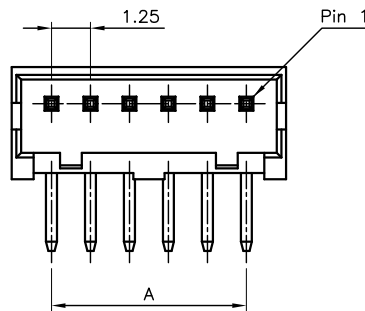
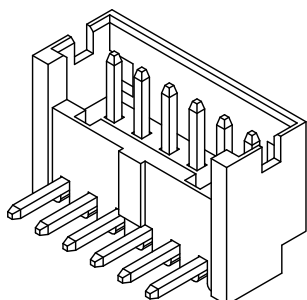

PCB PATTREN LAYOUT

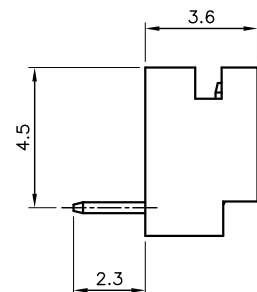
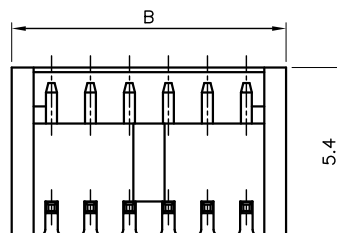

Ordering Information and Dimensions

CIRCUITS	PART NO.	DIMENSION	
		A	B
2	1255-WR-02P	1.25	3.80
3	1255-WR-03P	2.50	5.05
4	1255-WR-04P	3.75	6.30
5	1255-WR-05P	5.00	7.55
6	1255-WR-06P	6.25	8.80
7	1255-WR-07P	7.50	10.05
8	1255-WR-08P	8.75	11.30

CIRCUITS	PART NO.	DIMENSION	
		A	B
9	1255-WR-09P	10.00	12.55
10	1255-WR-10P	11.25	13.80
11	1255-WR-11P	12.50	15.05
12	1255-WR-12P	13.75	16.30
13	1255-WR-13P	15.00	17.55
14	1255-WR-14P	16.25	18.80
15	1255-WR-15P	17.50	20.05

1.25mm .049" Center Wire to Board Connector



1255 Series

■ WAFER

- Part No.: 1255-SMTS-xxP

Specifications

- Electrical
- Voltage Rating: 100V AC, DC
- Current Rating: 1A
- Withstanding Voltage: 500V AC/ minute.
- Insulation Resistance: 500MΩ Min
- Contact Resistance: 30mΩ Max
- Mates with: 1255-H-xxP

Material

- Circuits: 2~15
- Housing: Nylon 6T, UL 94V-0
- Pin: Brass, Gold plated
- Fitting: Phosphor Bronze, Gold plated
- Temperature Range: -25~+85°C

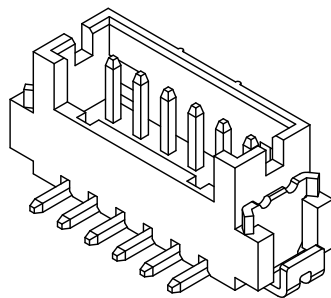
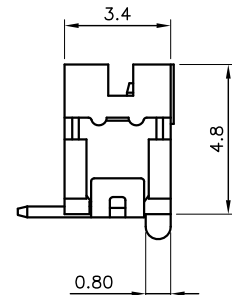
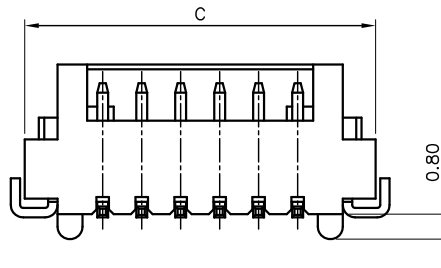
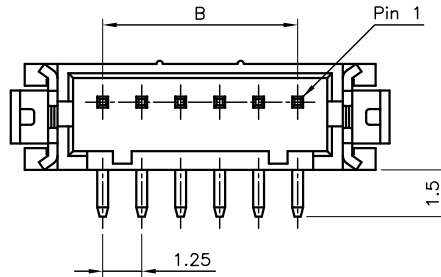
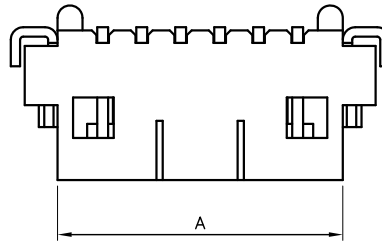

Ordering Information and Dimensions

CIRCUITS	PART NO.	DIMENSION		
		A	B	C
2	1255-SMTS-02P	4.15	1.25	6.25
3	1255-SMTS-03P	5.40	2.50	7.50
4	1255-SMTS-04P	6.65	3.75	8.75
5	1255-SMTS-05P	7.90	5.00	10.00
6	1255-SMTS-06P	9.15	6.25	11.25
7	1255-SMTS-07P	10.40	7.50	12.50
8	1255-SMTS-08P	11.65	8.75	13.75
9	1255-SMTS-09P	12.90	10.00	15.00
10	1255-SMTS-10P	14.15	11.25	16.25
11	1255-SMTS-11P	15.40	12.50	17.50
12	1255-SMTS-12P	16.65	13.75	18.75
13	1255-SMTS-13P	17.90	15.00	20.00
14	1255-SMTS-14P	19.15	16.25	21.25
15	1255-SMTS-15P	20.40	17.50	22.50

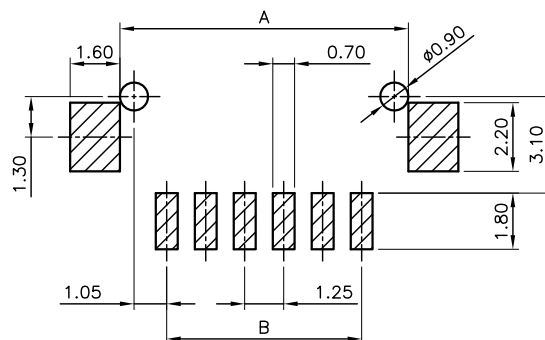

PCB PATTREN LAYOUT

1.25mm .049" Center Wire to Board Connector



1255 Series

■ WAFER

• Part No.: 1255-SMTR-xxP

Specifications

- Electrical
- Voltage Rating: 100V AC, DC
- Current Rating: 1A
- Withstanding Voltage: 500V AC/ minute.
- Insulation Resistance: 500MΩ Min
- Contact Resistance: 30mΩ Max
- Mates with: 1255-H-xxP

Material

- Circuits: 2~15
- Housing: Nylon 6T, UL 94V-0
- Pin: Brass, Gold plated
- Fitting: Phosphor Bronze, Gold plated
- Temperature Range: -25~+85°C

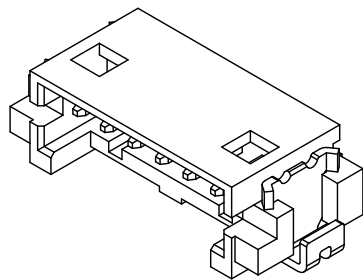
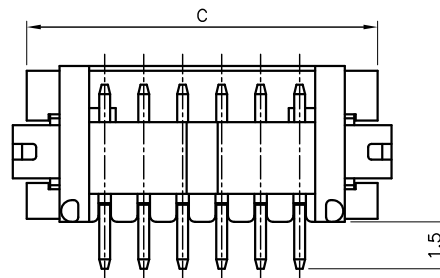
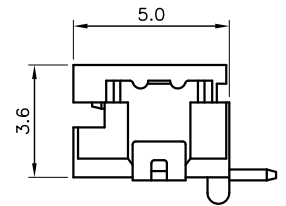
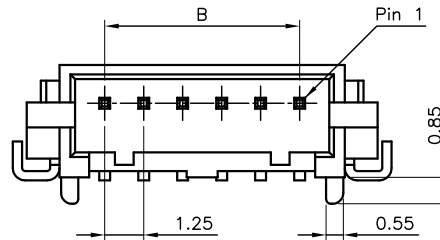
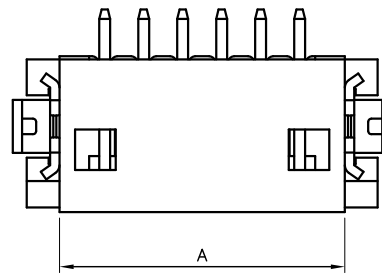

Ordering Information and Dimensions

CIRCUITS	PART NO.	DIMENSION		
		A	B	C
2	1255-SMTR-02P	4.15	1.25	6.25
3	1255-SMTR-03P	5.40	2.50	7.50
4	1255-SMTR-04P	6.65	3.75	8.75
5	1255-SMTR-05P	7.90	5.00	10.00
6	1255-SMTR-06P	9.15	6.25	11.25
7	1255-SMTR-07P	10.40	7.50	12.50
8	1255-SMTR-08P	11.65	8.75	13.75
9	1255-SMTR-09P	12.90	10.00	15.00
10	1255-SMTR-10P	14.15	11.25	16.25
11	1255-SMTR-11P	15.40	12.50	17.50
12	1255-SMTR-12P	16.65	13.75	18.75
13	1255-SMTR-13P	17.90	15.00	20.00
14	1255-SMTR-14P	19.15	16.25	21.25
15	1255-SMTR-15P	20.40	17.50	22.50

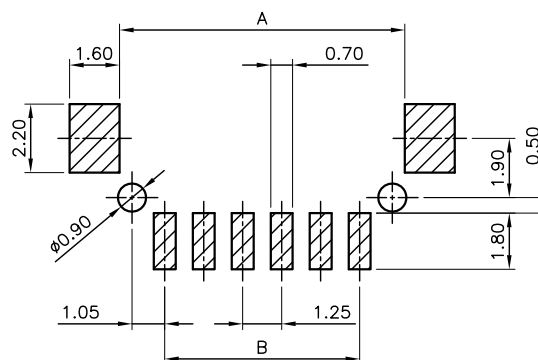

PCB PATTREN LAYOUT

1.25mm .049" Center Wire to Board Connector



1255 Series

■ WAFER

- Part No.: 1255-SMETS-2×xxP

Specifications

- Electrical
- Voltage Rating: 100V AC, DC
- Current Rating: 1A
- Withstanding Voltage: 500V AC/ minute.
- Insulation Resistance: 500MΩ Min
- Contact Resistance: 30mΩ Max
- Mates with: 1255-H-2×xxP

Material

- Circuits: 10, 20, 30, 40
- Housing: Thermal Plastic, UL 94V-0
- Cover: Thermal Plastic, UL 94V-0
- Terminal: Copper, Gold plated
- Fitting: Copper, Gold plated
- Temperature Range: -25~+85°C

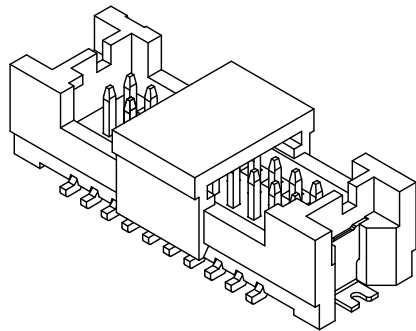
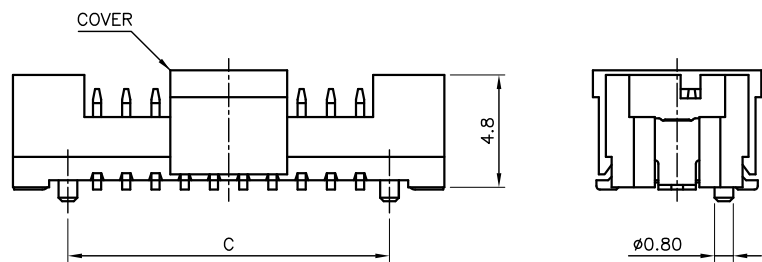
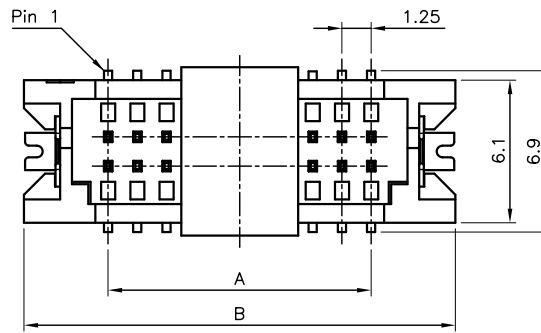

Ordering Information and Dimensions

CIRCUITS	PART NO.	DIMENSION		
		A	B	C
10	1255-SMETS-2×5P	5.00	12.20	7.50
20	1255-SMETS-2×10P	11.25	18.45	13.75
30	1255-SMETS-2×15P	17.50	24.70	20.00
40	1255-SMETS-2×20P	23.75	30.95	26.25

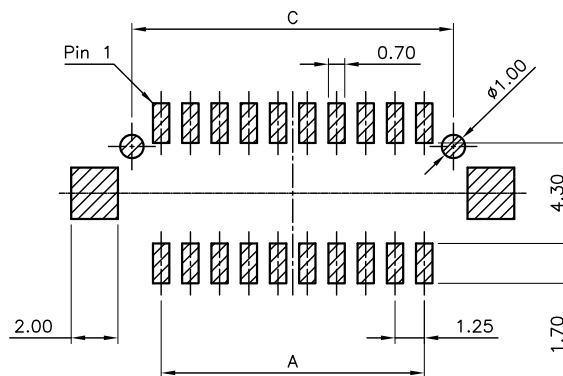

PCB PATTREN LAYOUT