

1.00mm .039" Center Wire to Board Connector



1016 Series

■ TERMINAL

• Part No.: 1016-T-T-S

- Material: Phosphor Bronze
- Thickness: 0.12mm
- Plating: Tin plated
- Applicable Wire: AWG#28~32
- Insulation O.D.: 0.90mm (Max)

• Accepts housing: 1016-H-xxP

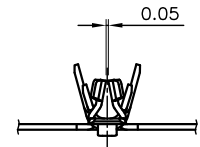
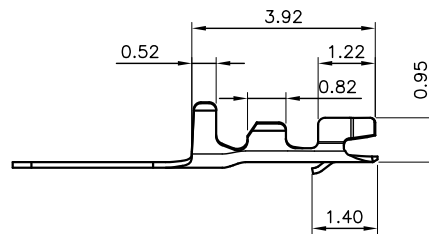
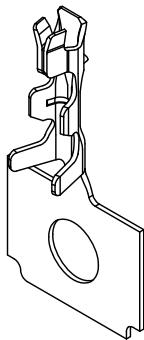
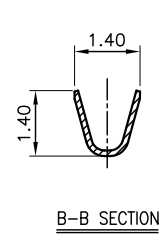
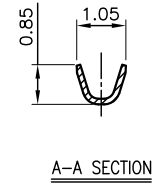
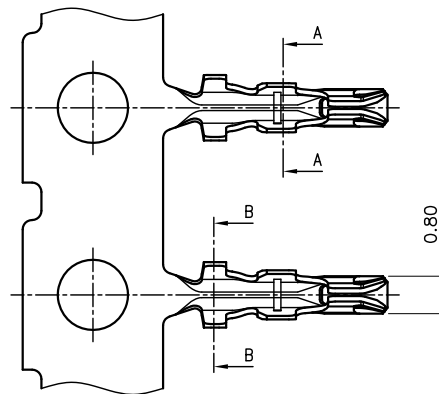

1016 Series

■ HOUSING

• Part No.: 1016-H-xxP

- Material: Nylon 66, UL 94V-0
- Pitch: 1.00mm (.039")
- Circuits: 2~20
- Color: White
- Accepts terminal: 1016-T-T-S

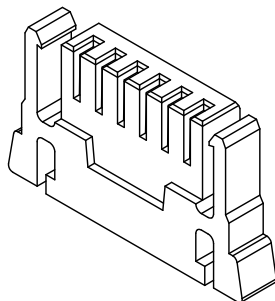
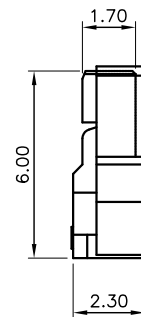
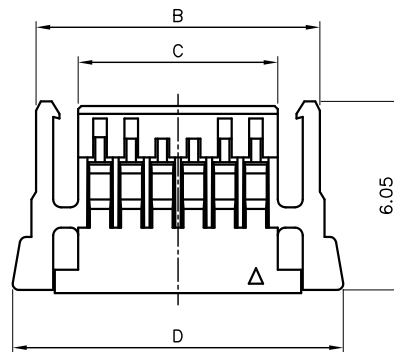
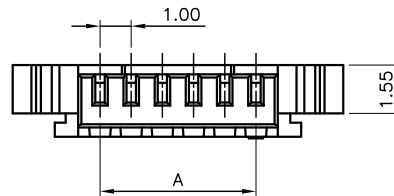

Ordering Information and Dimensions

CIRCUITS	DIMENSION			
	A	B	C	D
2	1.00	5.1	2.40	6.6
3	2.00	6.1	3.40	7.6
4	3.00	7.1	4.40	8.6
5	4.00	8.1	5.40	9.6
6	5.00	9.1	6.40	10.6
7	6.00	10.1	7.40	11.6
8	7.00	11.1	8.40	12.6

CIRCUITS	DIMENSION			
	A	B	C	D
9	8.00	12.1	9.40	13.6
10	9.00	13.1	10.40	14.6
11	10.00	14.1	11.40	15.6
12	11.00	15.1	12.40	16.6
13	12.00	16.1	13.40	17.6
14	13.00	17.1	14.40	18.6
15	14.00	18.1	15.40	19.6

CIRCUITS	DIMENSION			
	A	B	C	D
16	15.00	19.1	16.40	20.6
17	16.00	20.1	17.40	21.6
18	17.00	21.1	18.40	22.6
19	18.00	22.1	19.40	23.6
20	19.00	23.1	20.40	24.6