

# 1.00mm .039" Center Wire to Board Connector



## 1010 Series

### ■ WAFER

- Part No.: 1010-SMSTS-xxP

### Specifications

- Electrical
- Voltage Rating: 50V AC, DC
- Current Rating: 1A AC, DC (AWG#28)
- Withstanding Voltage: 250V AC/ minute.
- Insulation Resistance: 100MΩ Min
- Contact Resistance: 20mΩ Max
- Mates with: 1010-H-xxP  
1011-H-xxP

### Material

- Circuits: 2~20
- Housing: Thermal Plastic, UL 94V-0
- Terminal: Copper Alloy, Gold plated  
Tin plated
- Fitting: Copper Alloy, Tin plated
- Temperature Range: -25~+85°C

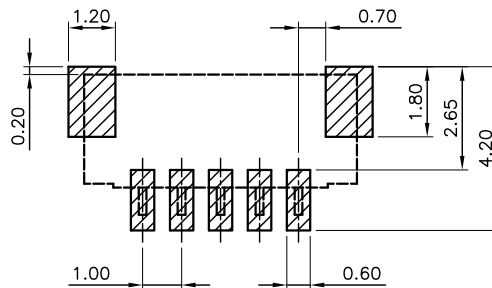
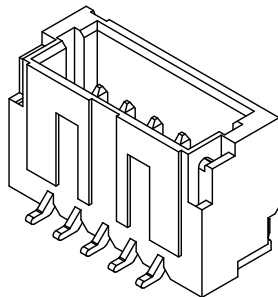
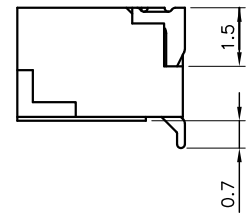
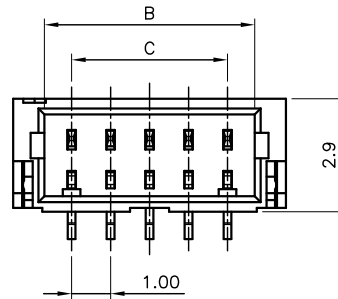
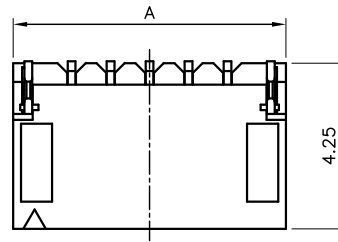

PCB PATTREN LAYOUT

## Ordering Information and Dimensions

CIRCUITS	PART NO.	DIMENSION		
		A	B	C
2	1010-SMSTS-02P	4.00	2.40	1.00
3	1010-SMSTS-03P	5.00	3.40	2.00
4	1010-SMSTS-04P	6.00	4.40	3.00
5	1010-SMSTS-05P	7.00	5.40	4.00
6	1010-SMSTS-06P	8.00	6.40	5.00
7	1010-SMSTS-07P	9.00	7.40	6.00
8	1010-SMSTS-08P	10.00	8.40	7.00
9	1010-SMSTS-09P	11.00	9.40	8.00
10	1010-SMSTS-10P	12.00	10.40	9.00
11	1010-SMSTS-11P	13.00	11.40	10.00

CIRCUITS	PART NO.	DIMENSION		
		A	B	C
12	1010-SMSTS-12P	14.00	12.40	11.00
13	1010-SMSTS-13P	15.00	13.40	12.00
14	1010-SMSTS-14P	16.00	14.40	13.00
15	1010-SMSTS-15P	17.00	15.40	14.00
16	1010-SMSTS-16P	18.00	16.40	15.00
17	1010-SMSTS-17P	19.00	17.40	16.00
18	1010-SMSTS-18P	20.00	18.40	17.00
19	1010-SMSTS-19P	21.00	19.40	18.00
20	1010-SMSTS-20P	22.00	20.40	19.00

# 1.00mm .039" Center Wire to Board Connector



## 1010 Series

### ■ WAFER

- Part No.: 1010-SMTR-xxP

### Specifications

- Electrical
- Voltage Rating: 50V AC, DC
- Current Rating: 1A AC, DC (AWG#28)
- Withstanding Voltage: 250V AC/ minute.
- Insulation Resistance: 100MΩ Min
- Contact Resistance: 20mΩ Max
- Mates with: 1010-H-xxP  
1011-H-xxP

### Material

- Circuits: 2~20
- Housing: Thermal Plastic, UL 94V-0
- Terminal: Copper Alloy, Gold plated  
Tin plated
- Fitting: Copper Alloy, Tin plated
- Temperature Range: -25~+85°C

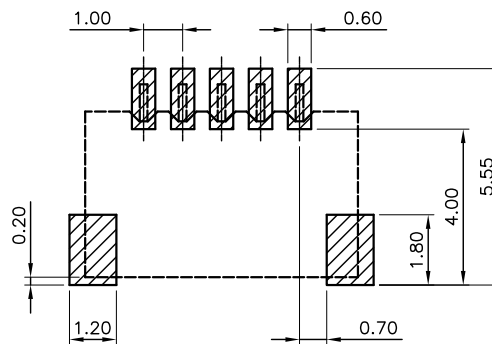
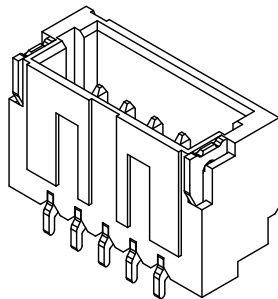
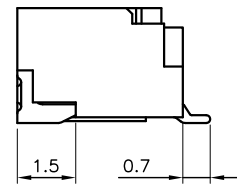
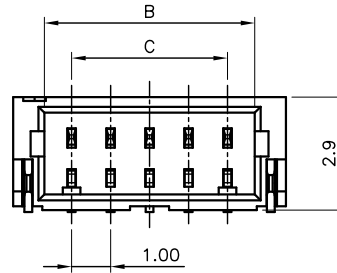
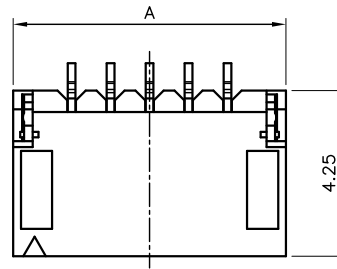

PCB PATTREN LAYOUT

## Ordering Information and Dimensions

CIRCUITS	PART NO.	DIMENSION		
		A	B	C
2	1010-SMTR-02P	4.00	2.40	1.00
3	1010-SMTR-03P	5.00	3.40	2.00
4	1010-SMTR-04P	6.00	4.40	3.00
5	1010-SMTR-05P	7.00	5.40	4.00
6	1010-SMTR-06P	8.00	6.40	5.00
7	1010-SMTR-07P	9.00	7.40	6.00
8	1010-SMTR-08P	10.00	8.40	7.00
9	1010-SMTR-09P	11.00	9.40	8.00
10	1010-SMTR-10P	12.00	10.40	9.00
11	1010-SMTR-11P	13.00	11.40	10.00

CIRCUITS	PART NO.	DIMENSION		
		A	B	C
12	1010-SMTR-12P	14.00	12.40	11.00
13	1010-SMTR-13P	15.00	13.40	12.00
14	1010-SMTR-14P	16.00	14.40	13.00
15	1010-SMTR-15P	17.00	15.40	14.00
16	1010-SMTR-16P	18.00	16.40	15.00
17	1010-SMTR-17P	19.00	17.40	16.00
18	1010-SMTR-18P	20.00	18.40	17.00
19	1010-SMTR-19P	21.00	19.40	18.00
20	1010-SMTR-20P	22.00	20.40	19.00

# 1.00mm .039" Center Wire to Board Connector



## 1010 Series

### ■ WAFER

- Part No.: 1010-SMTS-2×xxP

### Specifications

- Electrical
- Voltage Rating: 50V AC, DC
- Current Rating: 1A AC, DC (AWG#28)
- Withstanding Voltage: 500V AC/ minute.
- Insulation Resistance: 100MΩ Min
- Contact Resistance: 20mΩ Max
- Mates with: 1010-H-2×xxP

### Material

- Circuits: 10, 20, 30, 40, 50
- Housing: Thermal Plastic, UL 94V-0
- Terminal: Copper Alloy, Gold plated  
Tin plated
- Fitting: Copper Alloy, Tin plated
- Temperature Range: -25~+85°C

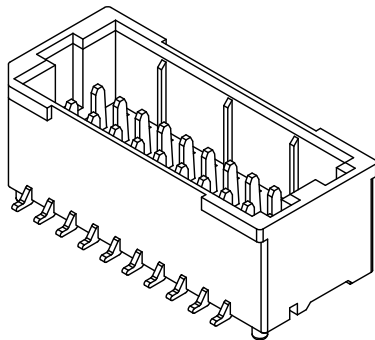
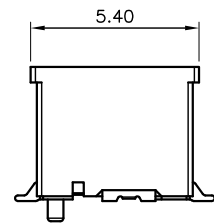
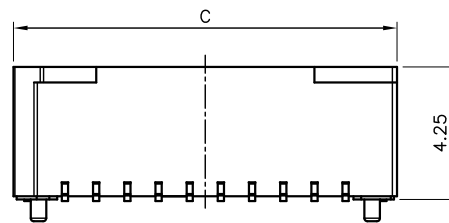
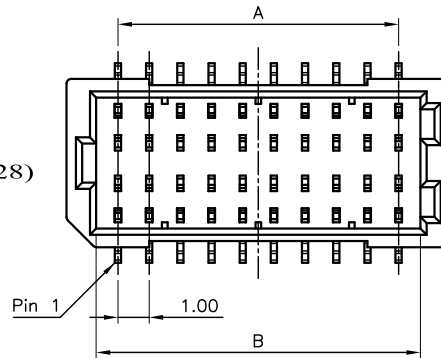

### Ordering Information and Dimensions

CIRCUITS	PART NO.	DIMENSION		
		A	B	C
10	1010-SMTS-2×05P	4.00	5.40	7.3
20	1010-SMTS-2×10P	9.00	10.40	12.3
30	1010-SMTS-2×15P	14.00	15.40	17.3
40	1010-SMTS-2×20P	19.00	20.40	22.3
50	1010-SMTS-2×25P	24.00	25.40	27.3

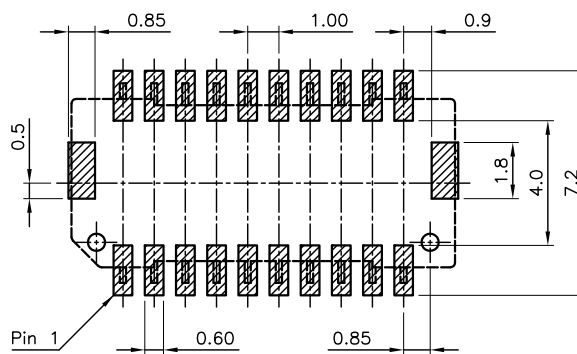

PCB PATTREN LAYOUT

# 1.00mm .039" Center Wire to Board Connector



## 1010 Series

### ■ WAFER

• Part No.: 1010-SMTR-2×xxP

### Specifications

- Electrical
- Voltage Rating: 50V AC, DC
- Current Rating: 1A AC, DC (AWG#28)
- Withstanding Voltage: 500V AC/ minute.
- Insulation Resistance: 100MΩ Min
- Contact Resistance: 20mΩ Max
- Mates with: 1010-H-2×xxP

### Material

- Circuits: 10, 20, 30, 40, 50
- Housing: Thermal Plastic, UL 94V-0
- Terminal: Copper Alloy, Gold plated  
Tin plated
- Fitting: Copper Alloy, Tin plated
- Temperature Range: -25~+85°C

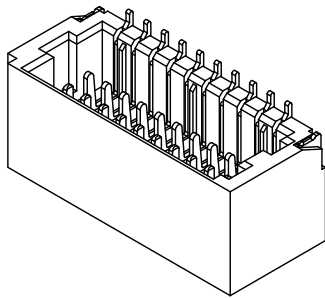
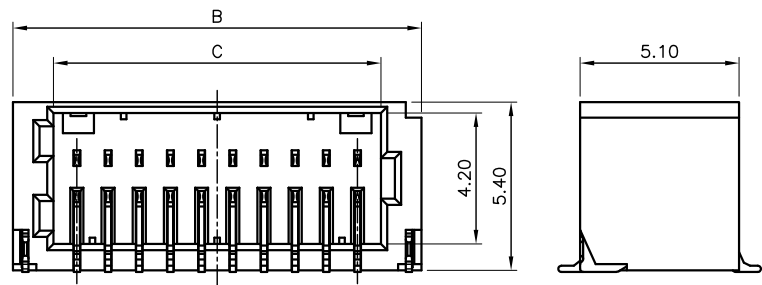
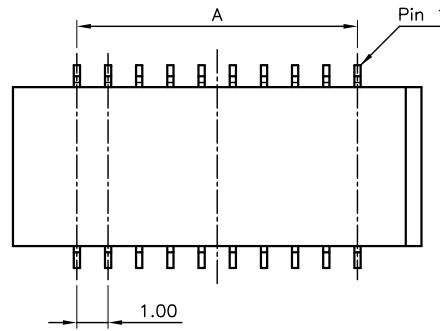

### Ordering Information and Dimensions

CIRCUITS	PART NO.	DIMENSION		
		A	B	C
10	1010-SMTR-2×05P	4.00	8.1	5.5
20	1010-SMTR-2×10P	9.00	13.1	10.5
30	1010-SMTR-2×15P	14.00	18.1	15.5
40	1010-SMTR-2×20P	19.00	23.1	20.5
50	1010-SMTR-2×25P	24.00	28.1	25.5

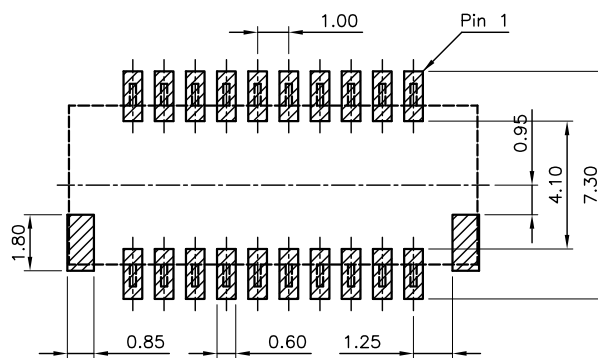

PCB PATTREN LAYOUT